



BALL VALVE

SERIES

High Performance Flanged end Ball Valve

MODEL

251 / 253 / 256

Product Introduction

DIMENSION LIST

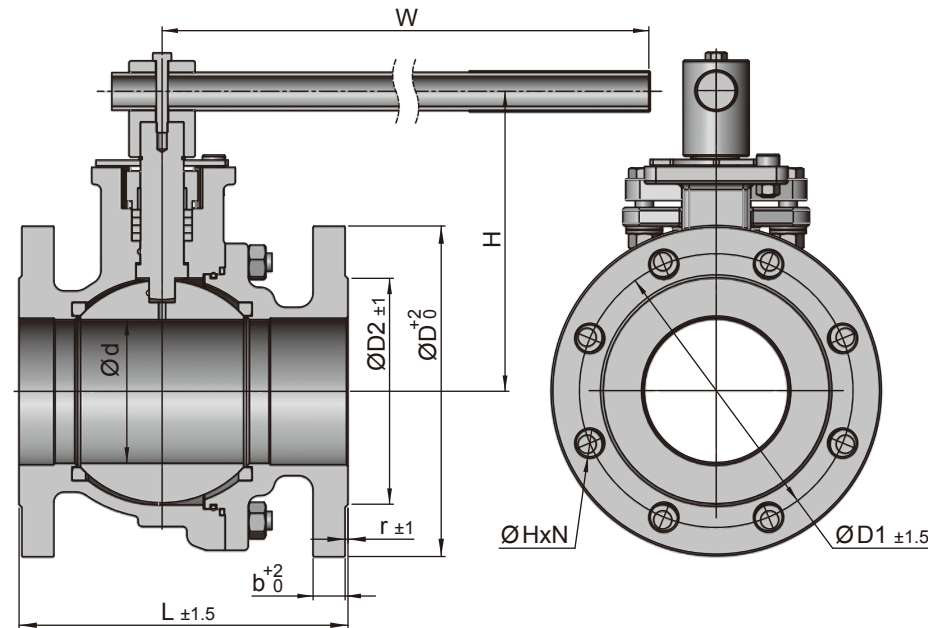

251 (Class 150)

SIZE	d	D2	D1	D	b	r	L	ØH-N	W	H	ISO5211
1/2"	16	34.9	60.3	90	8.5	2	108	16x4	136.5	91.6	F05
3/4"	20	42.9	69.9	100	8.9	2	117	16x4	136.5	91.6	F05
1"	25	50.8	79.4	110	9.6	2	127	16x4	186.5	107.9	F05
1-1/2"	38	73	98.4	125	12.7	2	165	16x4	230	119.8	F07
2"	50	92.1	120.7	150	14.3	2	178	19x4	230	138.5	F07
2-1/2"	65	104.8	139.7	180	15.9	2	190	19x4	350	170.4	F10
3"	80	127	152.4	190	17.5	2	203	19x4	350	190.3	F10
4"	100	157.2	190.5	230	22.3	2	229	19x8	400	208.8	F10
5"	127	185.7	216	255	22.3	2	356	22x8	400	233.5	F10
6"	152	215.9	241.3	280	23.9	2	394	22x8	800	279.8	F12
8"	203	269.9	298.5	345	27	2	457	22x8	1200	361.1	F14

253 (Class 300)

SIZE	d	D2	D1	D	b	r	L	ØH-N	W	H	ISO5211
1/2"	16	34.9	66.7	95	12.7	2	140	16x4	136.5	91.6	F05
3/4"	20	42.9	82.6	115	14.3	2	152	19x4	136.5	91.6	F05
1"	25	50.8	88.9	125	15.9	2	165	19x4	186.5	107.9	F05
1-1/2"	38	73	114.3	155	19.1	2	190	22x4	230	119.8	F07
2"	50	92.1	127	165	20.7	2	216	19x8	230	138.5	F07
2-1/2"	65	104.8	149.2	190	23.9	2	241	22x8	350	170.4	F10
3"	80	127	168.3	210	27	2	282	22x8	350	190.3	F10
4"	100	157.2	200	255	30.2	2	305	22x8	400	208.8	F10
5"	127	185.7	235	280	33.4	2	381	22x8	400	233.5	F10
6"	152	215.9	269.9	320	35	2	403	22x12	1200	323.1	F14
8"	203	269.9	330.2	380	39.7	2	502	25x12	1450	389.6	F16

256 (Class 600)

SIZE	d	D2	D1	D	b	r	L	ØH-N	W	H	ISO5211
1/2"	16	34.9	66.7	95	14.3	7	165	16x4	136.5	91.6	F05
3/4"	20	42.9	82.6	115	15.9	7	190	19x4	136.5	91.6	F05
1"	25	50.8	88.9	125	17.5	7	216	19x4	186.5	107.9	F05
1-1/2"	38	73	114.3	155	22.3	7	241	22x4	230	119.8	F07
2"	50	92.1	127	165	25.4	7	292	19x8	350	157.4	F07/F10
3"	80	127	168.3	210	31.8	7	356	22x8	400	198.5	F10
4"	100	157.2	215.9	275	38.1	7	432	25x8	800	254.8	F12

* 我方有權隨時變更材質/設計/規格，以便提供品質優良的產品。

We reserve the right to modify the design / specification without previous notice for better quality.

DIMENSIONS OF ISO MOUNTING PAD

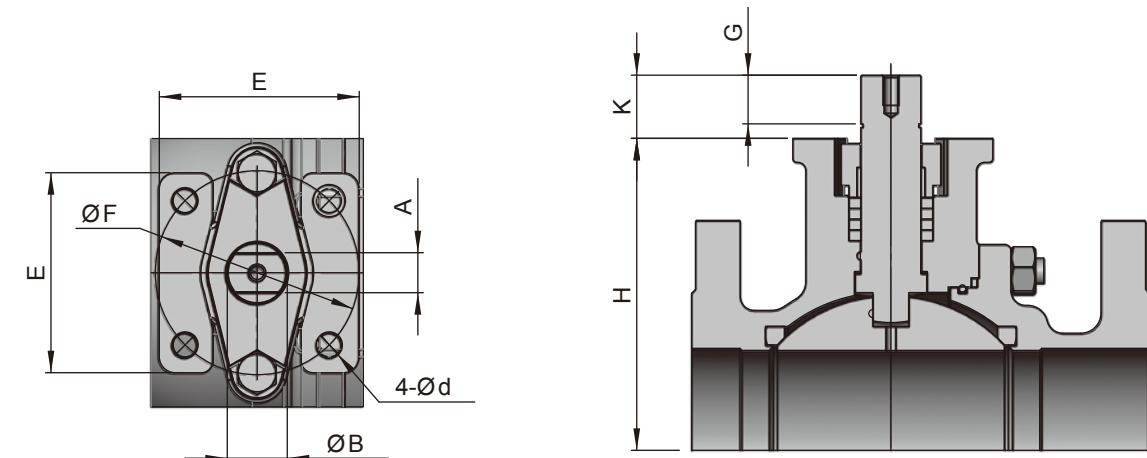

251 (Class 150)

SIZE	A	B	d	E	F	G	K	H	ISO5211
1/2"	8	12.7	7	50	50	10	11	57.1	F05
3/4"	8	12.7	7	50	50	10	11	57.1	F05
1"	9	16	7	50	50	10	10.8	68.6	F05
1-1/2"	12	18	10	70	70	16.5	22.4	81.1	F07
2"	14	19	10	70	70	18.4	24.2	100	F07
2-1/2"	16	24	12	95.5	102	24.9	31.7	117.5	F10
3"	20	30	12	95.5	102	24.4	31.6	137.5	F10
4"	20	30	12	100	102	24.4	31.6	156	F10
5"	20	30	12	100	102	25.1	32.3	180	F10
6"	26	38	14	115	125	28.6	36.5	218	F12
8"	32	48	18	137.5	140	40	50.5	283	F14

253 (Class 300)

SIZE	A	B	d	E	F	G	K	H	ISO5211
1/2"	8	12.7	7	50	50	10	11	57.1	F05
3/4"	8	12.7	7	50	50	10	11	57.1	F05
1"	9	16	7	50	50	10	10.8	68.6	F05
1-1/2"	12	18	10	70	70	16.5	22.4	81.1	F07
2"	14	19	10	70	70	18.4	24.2	100	F07
2-1/2"	16	24	12	95.5	102	24.9	31.7	117.5	F10
3"	20	30	12	95.5	102	24.4	31.6	137.5	F10
4"	20	30	12	100	102	24.4	31.6	156	F10
5"	20	30	12	100	102	25.1	32.3	180	F10
6"	32	48	18	137.5	140	40	50.5	245	F14
8"	40	58	22	165	165	50.9	61.4	301	F16

256 (Class 600)

SIZE	A	B	d	E	F	G	K	H	ISO5211
1/2"	8	12.7	7	50	50	10	11	57.1	F05
3/4"	8	12.7	7	50	50	10	11	57.1	F05
1"	9	16	7	50	50	10	10.8	68.6	F05
1-1/2"	12	18	10	70	70	16.5	22.4	81.1	F07
2"	16	24	10/12	98	70/102	19.9	26.7	106	F07/F10
3"	20	30	12	102	102	25	32.3	145	F10
4"	26	38	14	115	125	28.2	36.1	193	F12

* 我方有權隨時變更材質/設計/規格，以便提供品質優良的產品。

We reserve the right to modify the design / specification without previous notice for better quality.

